

MAL Series Aluminum Alloy Mini Cylinder

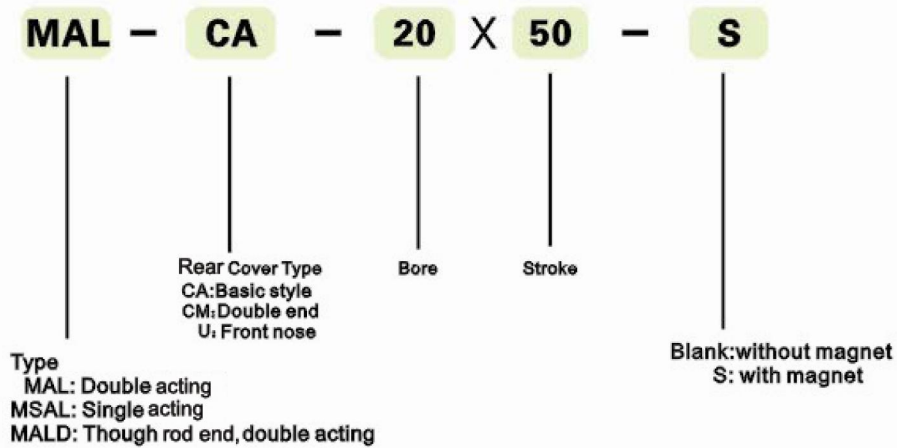

How to Order



Standard Stroke

Bore (mm)	Standard Stroke															
16	25	50	75	80	100	125	150	160	175	200						
20	25	50	75	80	100	125	150	160	175	200	250	300				
25	25	50	75	80	100	125	150	160	175	200	250	300	350	400	450	500
32	25	50	75	80	100	125	150	160	175	200	250	300	350	400	450	500
40	25	50	75	80	100	125	150	160	175	200	250	300	350	400	450	500



Technical data

Bore (mm)	16	20	25	32	40
Acting type	Double acting or single acting				
Working medium	Filtered air				
Mouting accessories	LB, FA, SDB				
Operating pressure range	0.1~0.9 Mpa				
Max. Pressure	1.35Mpa				
Operating temperature range	0~70°C				
Operating speed range	50~800 mm/s				
Cushioning type	Rubber bumper				
Port connection	M5x0.8	G1/8"			



Dimensions(mm) :

● MAL-CA:Basic style, integrated clevis

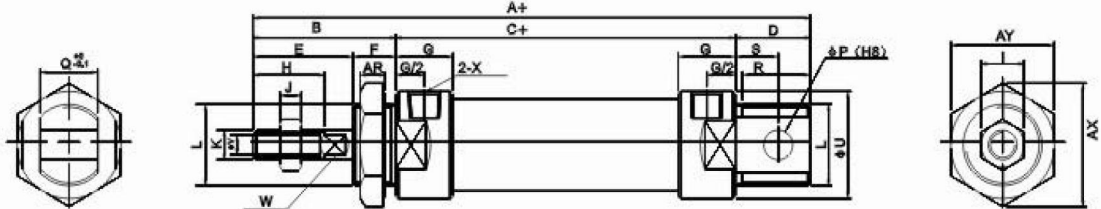

● MAL-CM:Double end

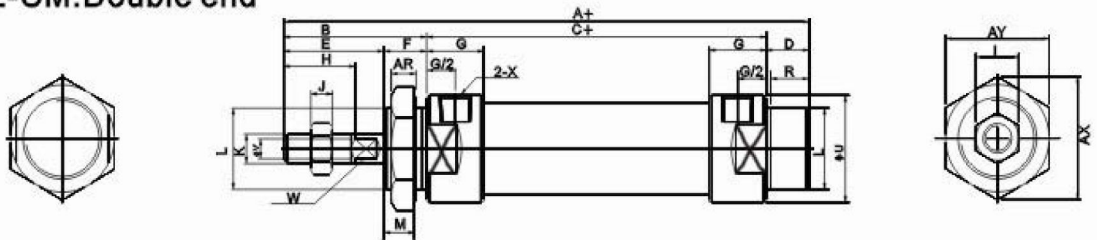

● MAL-U:Front nose

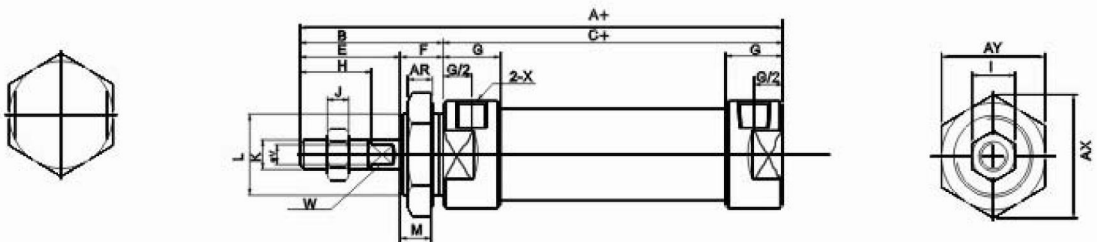

Bore	A	A1	A2	B	C	D	D1	E	F	G	H	I	J	K	L
16	104	104	90	38	52	15	15	24	14	11	16	10	5	M6 X 1	M16 X 1.5
20	131	122	110	40	70	21	12	28	12	16	20	12	6	M8 X 1.25	M22 X 1.5
25	135	128	114	44	70	21	14	30	14	16	22	17	6	M10 X 1.25	M22 X 1.5
32	141	128	114	44	70	27	14	30	14	16	22	17	6	M10 X 1.25	M24 X 2.0
40	165	152	138	46	92	27	14	32	14	22	24	17	7	M12x1.25	M30X 2.0

Bore	M	P	Q	R	R1	S	U	V	W	X	AR	AX	AY
16	8	6	12	13	13	6	20	6	/	M5	7	24	27.5
20	10	8	16	19	12	12	29	8	6	G1/8	7	33	29
25	12	8	16	19	14	12	34	10	8	G1/8	7	33	29
32	12	10	16	25	14	15	39.5	12	10	G1/8	8	37	32
40	12	12	20	25	14	15	49.5	16	14	G1/8	9	47	41



Dimensions(mm):

● MSAL-CA:Basic style integrated clevis

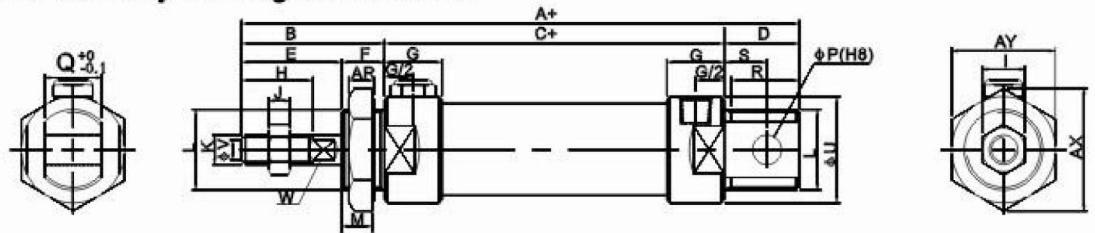

● MSAL-CM:Double end

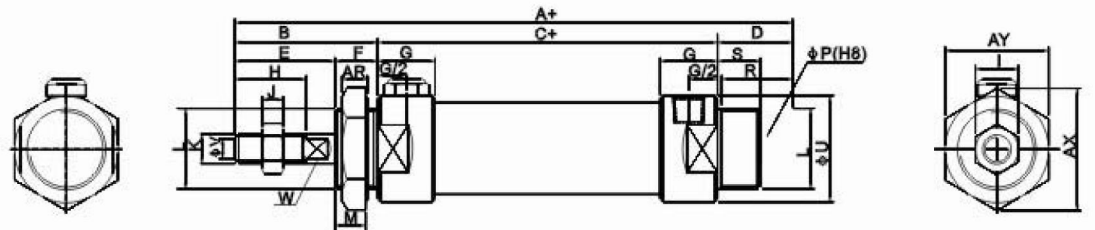

● MSAL-CM:Front nose

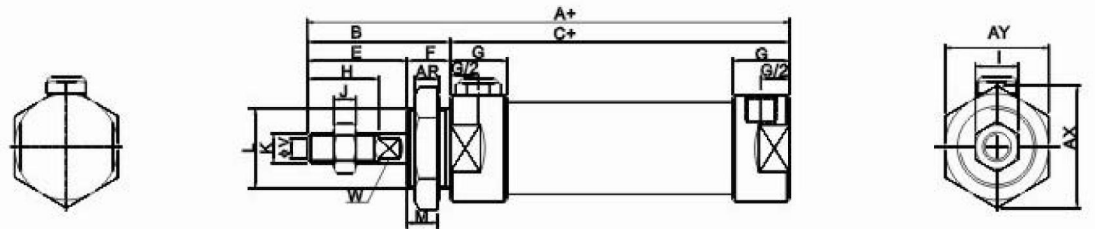

Bore/stroke	A		A1		A2		B	C		D	D1	E	F	G	H	I	J
	0~50	51~100	0~50	51~100	0~50	51~100		0~50	51~100								
20	131	156	122	147	110	135	40	70	95	21	12	28	12	16	20	12	6
25	135	160	128	153	114	139	44	70	95	21	14	30	14	16	22	17	6
32	141	166	128	153	114	139	44	70	95	27	14	30	14	16	22	17	6
40	165	190	152	177	138	163	46	92	117	27	14	32	14	22	24	17	7

Bore	K	L	M	P	Q	R	R1	S	U	V	W	X	AR	AX	AY
20	M8 X 1.25	M22 X 1.5	10	8	16	19	12	12	29	8	6	G1/8	7	33	29
25	M10 X 1.25	M22 X 1.5	12	8	16	19	14	12	34	10	8	G1/8	7	33	29
32	M10 X 1.25	M24 X 2.0	12	10	16	25	14	15	39.5	12	10	G1/8	8	37	32
40	M12 X 1.25	M30 X 2.0	12	12	20	25	14	15	49.5	16	14	G1/4	9	47	41



Dimensions(mm):

● MALD: Through end rod

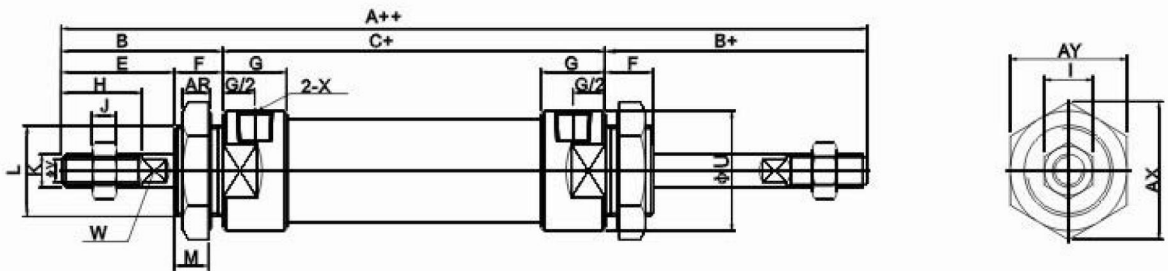

Bore	A	A1	B	C	E	F	G	H	I	I	K	L
20	131	122	40	70	28	12	16	20	12	6	M8 X 1.25	M22 X 1.5
25	135	128	44	70	30	14	16	22	17	6	M10 X 1.25	M22 X 1.5
32	141	128	44	70	30	14	16	22	17	6	M10 X 1.25	M24 X 2.0
40	165	152	46	92	32	14	22	24	17	7	M12 X 1.25	M30 X 2.0

Bore	M	U	V	W	X	AR	AX	AY	T
20	10	29	8	6	G1/8	7	33	29	19
25	12	34	10	8	G1/8	7	33	29	21
32	12	39.5	12	10	G1/8	8	37	32	21
40	12	49.5	16	14	G1/8	9	47	41	21